

7M
840,000/-
650/-
110/-



18/4/07 पश्चिम बंगाल WEST BENGAL

029163

SALE DEED, P.S. Durgapur, Mouza-Gopalmath, Area- 36 Decimal,
Value: Rs. 8, 29, 100/- , Under D.M.C. Sale Value: Rs. 4, 00, 000/-,

Fees Paid

J(i) - 250
J(ii) - 120
Paid on 17-4-07

Assessable under Rule 21 also
under section 5 of the W.B. A. A.
Fully stamped under the Indian
Stamp Act 1899
Schedule 1 A No 23
Doc paid - - - - -
S. Reg No. 107

Market value of the property assessed
Rs. 84,00,000/-
Deficit Stamp duty Rs. 650/-
Exemption by B/D or B/C of
S.B.I. Reg. No. 017104
di. 28/4/07
Rs. 100/-
has been realized paid by J. P. Lawerem.

Addl. Dist. Sub-Registrar
Durgapur, Dist. Burdwan

A fee Rs. 9119/-
received on 17-4-07

Addl. Dist. Sub-Registrar
Durgapur, Burdwan

Collector
U/S 41 & 42 (9)
ADAR Durgapur
28/4/07

17-4-07
18-4-07

25 APR 2007

828101
19750
Sale
5123

Sik. Anandamoy

THIS INDENTURE OF CONVEYANCE made this the 17 th
day of April, 2007 BETWEEN Sri Anandamoy Mukherjee,
S/O. Late Haripada Mukherjee, by faith Hindu, by natio-
nality Indian, by occupation-Business, resident of
Gopalmath Banagram Plot, Durgapur-1/, P.S. , Sub-division
& Sub-registry office Durgapur, Dist. Burdwan, W.B.,

193 4920/1500 + 1000 + 300 + 1000 + 1000

Presented For Registration at
 5-40 P.m on the 16/4/07
 at the District Registrar's Office by Anandmay Mukherjee



Ananda May Mukherjee

Adm. Dist. Sub-Registrar
 Burdwan, Burdwan

17 APR 2007



V.C.T.9
 294

Ananda May Mukherjee

Anandmay Mukherjee
 s/o Late Han Pado Mukherjee
 Of Gopalnath, Baranagar plot
 Thane No. DGP-17
 Dist. in Burdwan
 by assets - 2

Swapan Kumar Banerjee
 s/o Late Maindra Mohan Banerjee
 Of Gopalnath, DGP-17
 Thane No. DGP-17
 Dist. in Burdwan
 by assets - 2

Swapan Kumar Banerjee
 s/o Late Maindra Mohan Banerjee
 Gopalnath. DGP-17

Adm. Dist. Sub-Registrar



পশ্চিমবঙ্গ পশ্চিম বঙ্গাল WEST BENGAL

011442

: 2 :

8x Alimuddin

hereinafter referred to as the VENDOR (which expression shall unless excluded by or repugnant to the subject or context be deemed to include his heirs, executors, administrators, representatives, successors and assigns) of the ONE PART;

A N D

Contd...P/3.

193

SOLD TO DISCOUNT/...

of Burdwan

FROM ARABIAN TREASURY

49200 + 2000 + 2000 + 3000 + 1000 + 2500

STAMP

ARABIAN TREASURY



Edl. Dist. Sub-Registrar
Burdwan

18 APR 2007



Sr. M. M. Uddin.

Sri Jaspal Singh Panesar , S/O. Sri Gurdayal Singh Paneshwar , by faith Hindu , by nationality Indian, by occupation Business, resident of Nachan Road, Bhiringi, Durgapur-13, P.S., Sub-division & Sub-registry office - Durgapur, Dist. Burdwan, W.B., hereinafter referred to as the PURCHASER (which expression shall unless excluded by or repugnant to the subject or context be deemed

193
CASH TO BUDGET/2500 + 2000 + 3000 + 1000 + 750
Dwight
16/4/19
16/4/19
STAN. CLERE
AMAND. TREASURY

had no objection to the subject of contract be deemed
as the Foreman, which objection shall unless exclu-
sively, this is, however, referred to
Paragraph 10, 11, 12, 13, 14, 15, 16, 17, 18, 19, 20, 21, 22, 23, 24, 25, 26, 27, 28, 29, 30, 31, 32, 33, 34, 35, 36, 37, 38, 39, 40, 41, 42, 43, 44, 45, 46, 47, 48, 49, 50, 51, 52, 53, 54, 55, 56, 57, 58, 59, 60, 61, 62, 63, 64, 65, 66, 67, 68, 69, 70, 71, 72, 73, 74, 75, 76, 77, 78, 79, 80, 81, 82, 83, 84, 85, 86, 87, 88, 89, 90, 91, 92, 93, 94, 95, 96, 97, 98, 99, 100, 101, 102, 103, 104, 105, 106, 107, 108, 109, 110, 111, 112, 113, 114, 115, 116, 117, 118, 119, 120, 121, 122, 123, 124, 125, 126, 127, 128, 129, 130, 131, 132, 133, 134, 135, 136, 137, 138, 139, 140, 141, 142, 143, 144, 145, 146, 147, 148, 149, 150, 151, 152, 153, 154, 155, 156, 157, 158, 159, 160, 161, 162, 163, 164, 165, 166, 167, 168, 169, 170, 171, 172, 173, 174, 175, 176, 177, 178, 179, 180, 181, 182, 183, 184, 185, 186, 187, 188, 189, 190, 191, 192, 193, 194, 195, 196, 197, 198, 199, 200, 201, 202, 203, 204, 205, 206, 207, 208, 209, 210, 211, 212, 213, 214, 215, 216, 217, 218, 219, 220, 221, 222, 223, 224, 225, 226, 227, 228, 229, 230, 231, 232, 233, 234, 235, 236, 237, 238, 239, 240, 241, 242, 243, 244, 245, 246, 247, 248, 249, 250, 251, 252, 253, 254, 255, 256, 257, 258, 259, 260, 261, 262, 263, 264, 265, 266, 267, 268, 269, 270, 271, 272, 273, 274, 275, 276, 277, 278, 279, 280, 281, 282, 283, 284, 285, 286, 287, 288, 289, 290, 291, 292, 293, 294, 295, 296, 297, 298, 299, 300, 301, 302, 303, 304, 305, 306, 307, 308, 309, 310, 311, 312, 313, 314, 315, 316, 317, 318, 319, 320, 321, 322, 323, 324, 325, 326, 327, 328, 329, 330, 331, 332, 333, 334, 335, 336, 337, 338, 339, 340, 341, 342, 343, 344, 345, 346, 347, 348, 349, 350, 351, 352, 353, 354, 355, 356, 357, 358, 359, 360, 361, 362, 363, 364, 365, 366, 367, 368, 369, 370, 371, 372, 373, 374, 375, 376, 377, 378, 379, 380, 381, 382, 383, 384, 385, 386, 387, 388, 389, 390, 391, 392, 393, 394, 395, 396, 397, 398, 399, 400, 401, 402, 403, 404, 405, 406, 407, 408, 409, 410, 411, 412, 413, 414, 415, 416, 417, 418, 419, 420, 421, 422, 423, 424, 425, 426, 427, 428, 429, 430, 431, 432, 433, 434, 435, 436, 437, 438, 439, 440, 441, 442, 443, 444, 445, 446, 447, 448, 449, 450, 451, 452, 453, 454, 455, 456, 457, 458, 459, 460, 461, 462, 463, 464, 465, 466, 467, 468, 469, 470, 471, 472, 473, 474, 475, 476, 477, 478, 479, 480, 481, 482, 483, 484, 485, 486, 487, 488, 489, 490, 491, 492, 493, 494, 495, 496, 497, 498, 499, 500, 501, 502, 503, 504, 505, 506, 507, 508, 509, 510, 511, 512, 513, 514, 515, 516, 517, 518, 519, 520, 521, 522, 523, 524, 525, 526, 527, 528, 529, 530, 531, 532, 533, 534, 535, 536, 537, 538, 539, 540, 541, 542, 543, 544, 545, 546, 547, 548, 549, 550, 551, 552, 553, 554, 555, 556, 557, 558, 559, 560, 561, 562, 563, 564, 565, 566, 567, 568, 569, 570, 571, 572, 573, 574, 575, 576, 577, 578, 579, 580, 581, 582, 583, 584, 585, 586, 587, 588, 589, 590, 591, 592, 593, 594, 595, 596, 597, 598, 599, 600, 601, 602, 603, 604, 605, 606, 607, 608, 609, 610, 611, 612, 613, 614, 615, 616, 617, 618, 619, 620, 621, 622, 623, 624, 625, 626, 627, 628, 629, 630, 631, 632, 633, 634, 635, 636, 637, 638, 639, 640, 641, 642, 643, 644, 645, 646, 647, 648, 649, 650, 651, 652, 653, 654, 655, 656, 657, 658, 659, 660, 661, 662, 663, 664, 665, 666, 667, 668, 669, 670, 671, 672, 673, 674, 675, 676, 677, 678, 679, 680, 681, 682, 683, 684, 685, 686, 687, 688, 689, 690, 691, 692, 693, 694, 695, 696, 697, 698, 699, 700, 701, 702, 703, 704, 705, 706, 707, 708, 709, 710, 711, 712, 713, 714, 715, 716, 717, 718, 719, 720, 721, 722, 723, 724, 725, 726, 727, 728, 729, 730, 731, 732, 733, 734, 735, 736, 737, 738, 739, 740, 741, 742, 743, 744, 745, 746, 747, 748, 749, 750, 751, 752, 753, 754, 755, 756, 757, 758, 759, 760, 761, 762, 763, 764, 765, 766, 767, 768, 769, 770, 771, 772, 773, 774, 775, 776, 777, 778, 779, 780, 781, 782, 783, 784, 785, 786, 787, 788, 789, 790, 791, 792, 793, 794, 795, 796, 797, 798, 799, 800, 801, 802, 803, 804, 805, 806, 807, 808, 809, 810, 811, 812, 813, 814, 815, 816, 817, 818, 819, 820, 821, 822, 823, 824, 825, 826, 827, 828, 829, 830, 831, 832, 833, 834, 835, 836, 837, 838,



to include his heirs, executors, administrators,
representatives, successors and assigns) of the
OTHER PART.

Dr. Sh. M. Uddin.

WHEREAS the land mentioned in the schedule below
has been purchased by the vendor by a registered deed
of sale being No. 3349 of Durgapur A.D.S.R. office in
the year 2000 and the schedule property has been

192
 40227 (500 + 2000 + 3000 + 1000 + 200)
 Jai Lal Singh
 Durgam Cheru
 16/4/07
 16/4/07
 STAM CLERK
 TREASURY



M
 District Registrar
 Durgam Cheru

18 APR 2007



: 5 :

recorded in the vendor's name in L.R. Record and the vendor is the absolute owner of the schedule land with his own possession.

NOW that the vendor is willing to leave this place and therefore willing to sell out the property schedule below.

Sx Shrimadhi.

1933 TOTAL AMOUNT 49222/5 in 4 rows a 3 in 1 row 1/2
 SOLD TO SUBSIDIARY/IN Gas bel ch. P. n. e. a. r
 BY Dur. d. a. p. u. s.
 FROM ARABIAN TREASURY ON 16/4/1933
 STAMP CLERK
 ARABIAN TREASURY



add. Dist. Sub-Registrar
 Burdwan, Burdwan

18 APR 2007

Recorded in the register of the District Registrar, Burdwan, on the 18th April 2007.
 The following is the description of the property:
 The property is situated in the village of ... and is bounded by ...
 The area of the property is ... and it is used for ...
 The property is being sold to the ... and the proceeds of the sale are to be ...
 The sale is being made in accordance with the provisions of the ...

ਭਾਰਤੀ ਪੰਜਾਬੀ ਭਾਸ਼ਾ ਵਿਭਾਗ

ਭਾਰਤੀ ਪੰਜਾਬੀ ਭਾਸ਼ਾ ਵਿਭਾਗ



Jaspal Singh Panesar

ਭਾਰਤੀ ਪੰਜਾਬੀ ਭਾਸ਼ਾ ਵਿਭਾਗ

ਭਾਰਤੀ ਪੰਜਾਬੀ ਭਾਸ਼ਾ ਵਿਭਾਗ

Jaspal Singh Panesar

ਭਾਰਤੀ ਪੰਜਾਬੀ ਭਾਸ਼ਾ ਵਿਭਾਗ

ਭਾਰਤੀ ਪੰਜਾਬੀ ਭਾਸ਼ਾ ਵਿਭਾਗ



Ananda Moy Mukherjee

ਭਾਰਤੀ ਪੰਜਾਬੀ ਭਾਸ਼ਾ ਵਿਭਾਗ

ਭਾਰਤੀ ਪੰਜਾਬੀ ਭਾਸ਼ਾ ਵਿਭਾਗ

Ananda Moy Mukherjee



Am
A.M. D. Registrar
Burdwan, Burdwan

18 APR 2007

WHEREAS the Purchaser was in quest of property and having come to know the whereabouts of the property with the consideration money of Rs.4,00,000/- (Rupees Four lakhs) only approached to the vendor.

AND the vendor taking it as the highest price agreed to sell the property schedule below to the purchaser accepting the consideration money of Rs.4,00,000/- (Rupees Four lakhs) only by Cheque.

NOW having received the consideration money of Rs.4,00,000/- (Rupees Four lakhs) only the vendor leaves the possession of the piece and parcel of land schedule below in favour of the purchaser.

NOW the vendor describes and declares that the scheduled property is being transferred to the purchaser by this deed of sale.

NOW the purchaser is the sole owner and proprietor of the land hereinafter described scheduled.

BY THIS DEED OF SALE the purchaser will have every right to transfer, sale etc. and wherever necessary if the purchaser deems fit he will use by any kind or any purpose of the schedule land and as he deems fit and will pay the rent and taxes in the respective offices at the rates prescribed and will make his name scheduled in the respective Rent and taxes registers of the respective offices.

See Annexure



M
Ed. Dist. Sub-Registrar
Durgam, Lucknow

18 APR 2007

The property hereinafter described in the schedule is free from all encumbrances and if any discrepancy found on my part I will be taken under the custody of the Court of law. The schedule property is being used for agricultural purposes.

- : S C H E D U L E : -

In the Dist. of Burdwan, Sub-division, Sub-registry office & P.S. Durgapur, Mouza - Gopalmath, J.L.No.54, Khatian No.R.S. 54 Fifty four, L.R. 762 Seven hundred sixty two,

1. Plot No.Old-556 Five hundred fifty six, New- 496 Four hundred ninety six, Baid , area - 16 Sixteen Decimal.
2. Plot No.Old-556 Five hundred fifty six, New- 497 Four hundred ninety seven, Baid , Area-20 Twenty Decimal.

SK dlim vdh.

Total measuring area in two plot - 36 Thirty six Decimal of land is only being sold. The area of the schedule land delineated in red mark in the sketch annexed hereto. The sketch is the part and parcel of this Deed.

Payable rent to be paid to the Collector Burdwan through B.L.& L.R.O. Durgapur, Dist. Burdwan.

Butted & Bounded by :- East - Gurdoyal Singh , West- Dr. Banerjee, North - Gopal Chatterjee, and South -G.T.Road.



[Signature]
Minister of Health and Family Welfare

18 APR 2007

It is hereby declared that the full name, colour passport size photograph and finger prints of each finger of both the hands of 1 No. of seller and 1 No. of purchaser are attested in additional pages in this deed being No.1(A) and these will be treated as a part of this Deed.

IN WITNESS WHEREOF the Vendor doth hereby put his signature on the day, month and year as set forth at the very out set at his own will and in sound health and consent.

WITNESSES:

Atulya Mukherjee
Atulya

1. Atulya Mukherjee
(Bonagram)

Ananda Moy Mukherjee

SIGNATURE OF THE VENDOR

Swapan Kumar Banerjee,
Gofalmata. DGP-17

DRAFTED, PREPARED,
READOVER & EXPLAINED BY ME :-

Sk Alimuddin.
Deed writer Durgapur
A.P.S.R. Office
Ln D.P.R. - 511
25

TYPED BY ME :-

Adhikari
TAPAN ADHIKARI
DURGAPUR-713216.



[Signature]
Sub-Registrar, Durgam Cheruvu, Hyderabad

18 APR 2007



[Signature]
Sub-Registrar, Durgam Cheruvu, Hyderabad

27 APR 2007

[Signature]
Sub-Registrar, Durgam Cheruvu, Hyderabad

SKETCH PLAN SHOWING MORE OR LESS 36 DECIMALS LAND
 BY RED BOUNDED IN LAYOUT PLOT NO-A BEING PORTION
 OF R.S. PLOT NO-556 OF MOUZA-GOPALMATH J.L. NO-54
 P.S.-DURGAPUR DIST- BURDWAN. SOLD TO- JASPAL
 SINGH PANESAR S/O GURDAYAL SINGH.

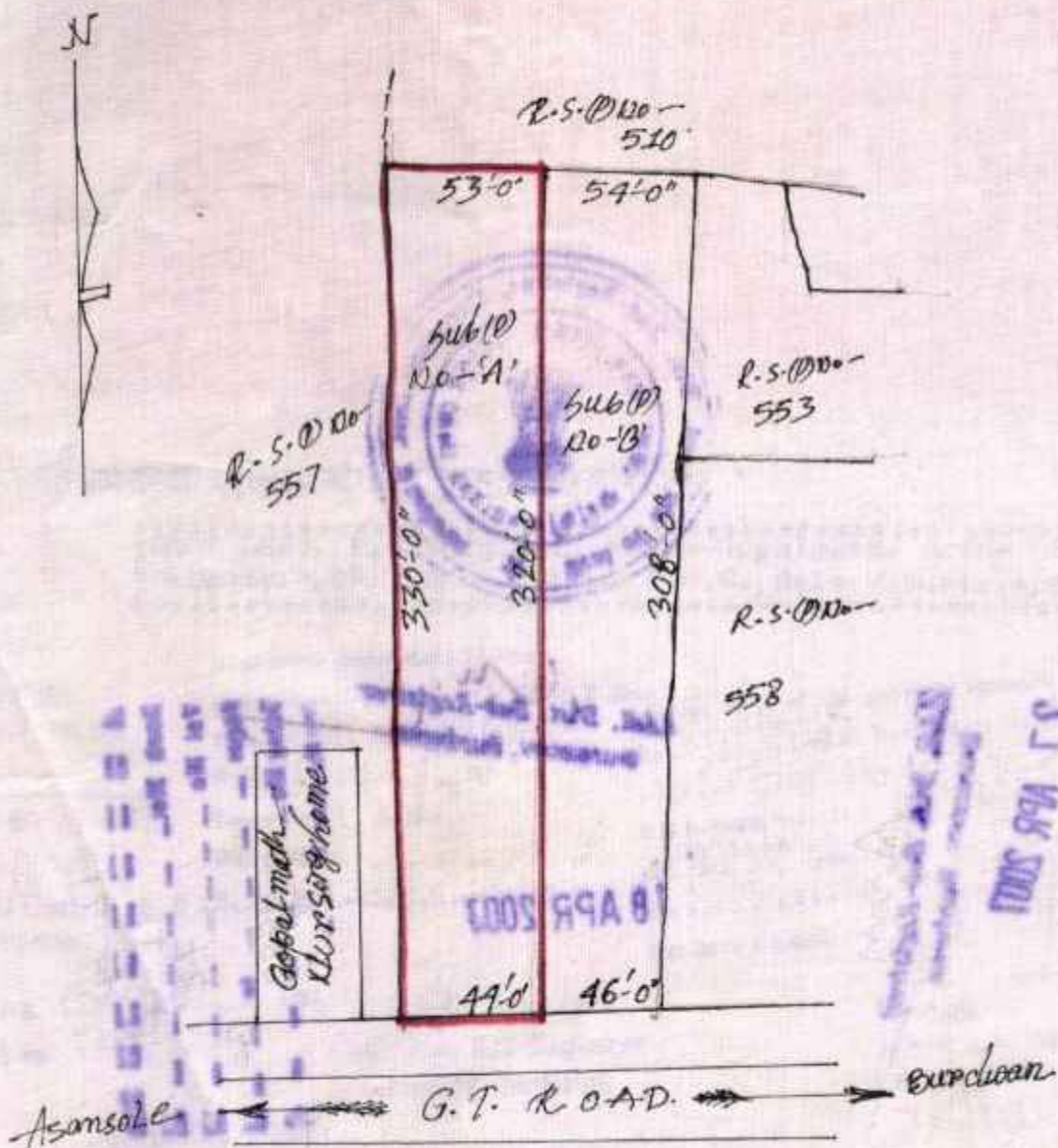

Drawn by
 A. Paul (P. M. S.)
 Registered 12.04.57
 Dated 12.04.57

Amranda May Mucherjee



ADD. Dist. Sub-Registrar
Burdwan, Burdwan

18 APR 2007

27 APR 2007

[Signature]
Dist. Sub-Registrar
Burdwan, Burdwan

22
Dist. No. ————
Vol No. ————
Page ————
Dist. No. ————
1883
72
30
27